

INNOSILICON

Replacement Steps of T2 PSU



REPLACEMENT STEPS OF T2 PSU



1. Please turn off the miner, then unplug the power cord on the control board and the hashboard.
2. There are five screws which connect the PSU to miner as you can see in Figure-1 and Figure-2 , please remove them.

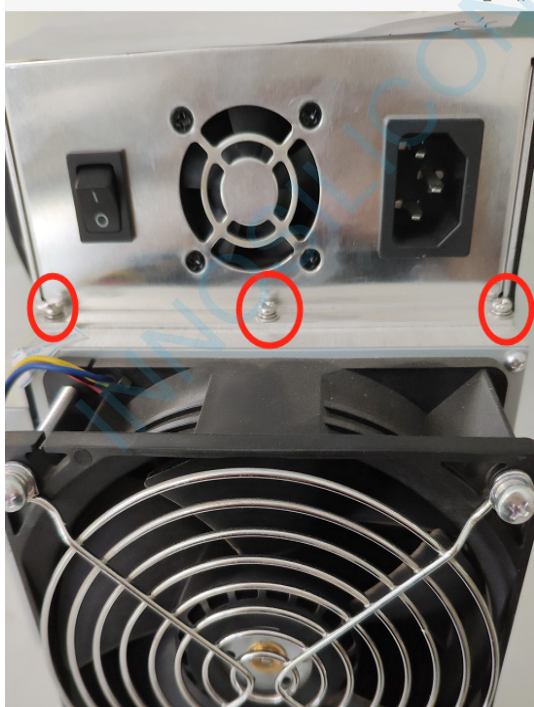

Figure 1

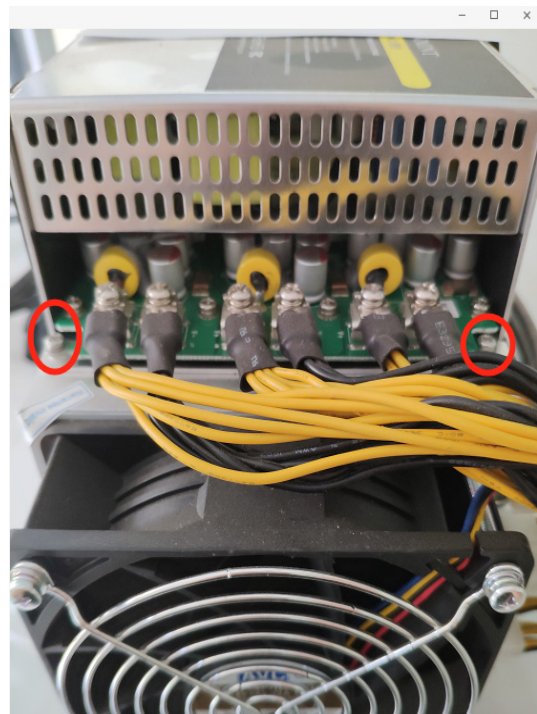

Figure 2

3. Fix the new power supply with the miner through screws , then connect the power cord with hashboard shown in Figure-3.

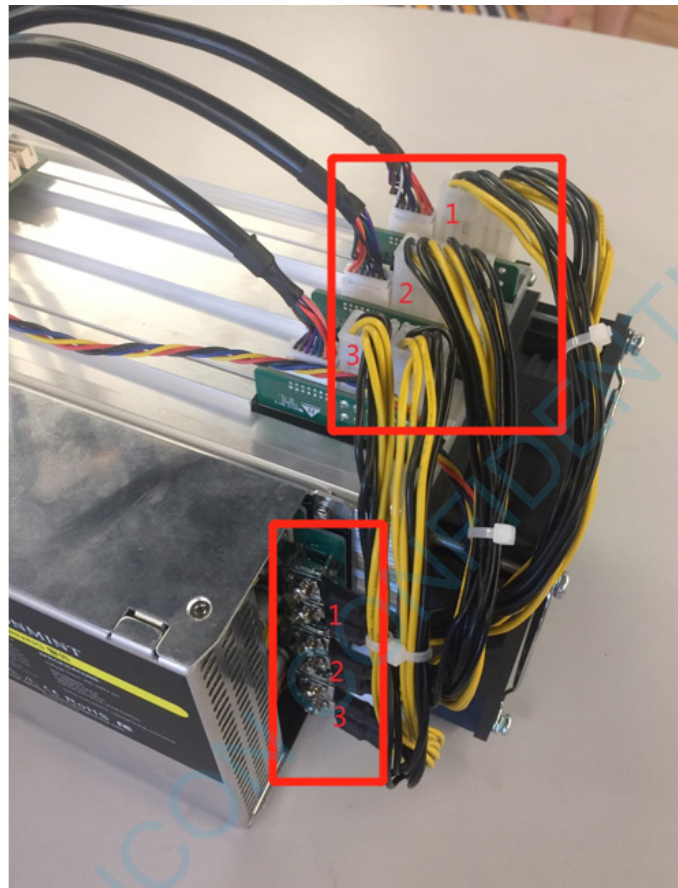

Figure 3